

CAT5, CAT6 and CAT7 Twisted Pair HDMI receiver with S/PDIF Digital Audio Output connector

Part No: 9152 0015

Highlight features

- Extends HDMI and DVI signals with HDCP
- Pixel Accurate Reclocking
- RS-232 pass through
- S/PDIF digital audio output



The HDMI-TP-RX100RA deep color receiver was designed to handle HDMI or DVI signals over two CAT5, CAT6 or CAT7 cables with or without HDCP encryption. HDMI-TP-RX100RA de-embeds digital audio from the HDMI stream and outputs via the S/PDIF connector.

Cross compatibility between all the devices in the product series is ensured thanks to Lightware's attentive design. Any transmitter can be paired with any receiver without restriction. With Lightware's Hybrid Modular Matrix concept, it is even possible to connect an extender box directly to the matrix router using an MX-HDMI-TP series output board.

Power source can be set by jumper for local supply with plug-in adapter, or for remote supply through TP CATx cable. All devices can be mounted on a rack shelf, or used in standalone formats.

Pixel Accurate Reclocking: The reclocking engine utilized in our 'pro' series routers can be uniquely found in Lightware 100 series Twisted Pair receivers. The circuitry cleans the signal from noise and jitter ensuring a stable recovered digital signal on output with sharp transitions and accurate timing.

Equalization on the receiver's RJ45 input connectors is available for both automatic adaptive or fine tunable manual operation. In manual mode the 25 turn trimpot allows the most accurate settings between 0 and 40dB values. This can help gain those extra few metres even at the highest 1080p resolution.

Stand alone diagram

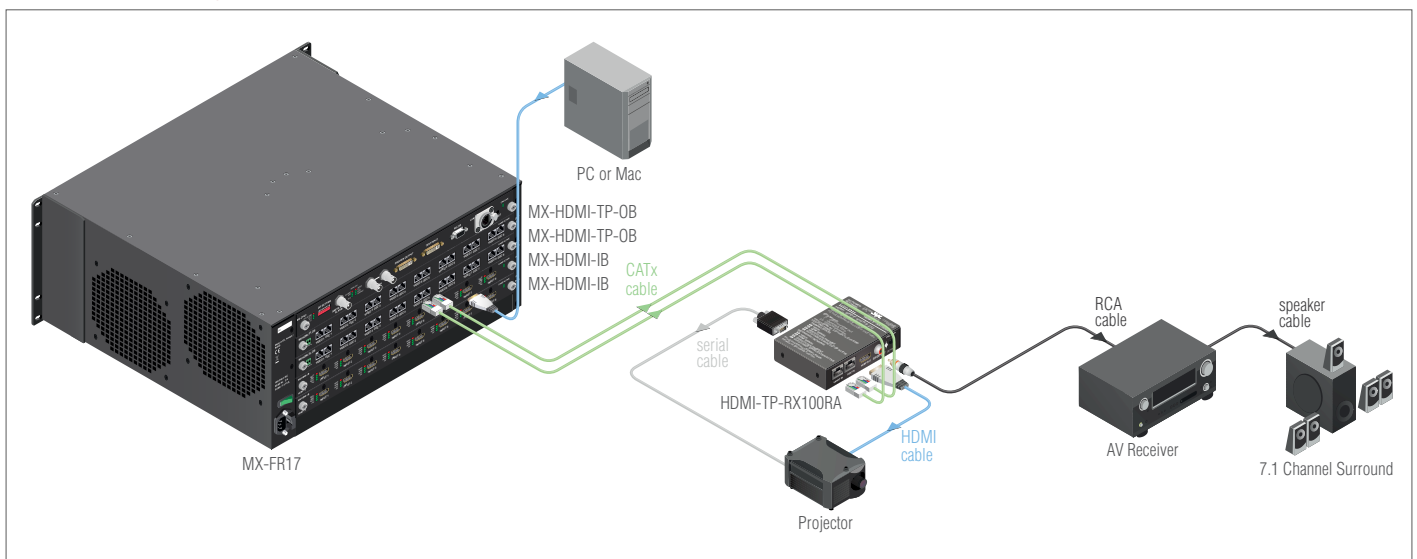

Applications

- Home theatre systems
- Digital Signage
- Training
- Simulation
- Conference rooms, collaborative telepresence

Features

- Extends HDMI 1.3a and DVI 1.0 signals with HDCP 1.1
- Supports Dolby TrueHD and DTS-HD Master Audio 7.1 formats
- 1920 x 1200 or 2048 x 1080 maximal resolutions
- S/PDIF digital audio output connector
- Cross compatibility with any Lightware Twisted Pair device
- Jumper selectable local or remote power source
- Precise manual or automatic adaptive cable equalization adjustment
- Pixel Accurate Reclocking
- RS-232 pass through
- USB control
- Metal housing for professional use and rack mounting

Locking DC plug

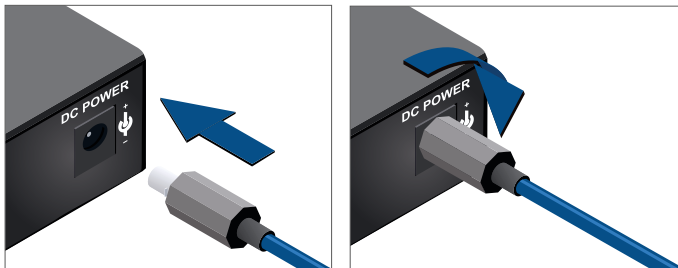

Twist 90° clockwise to lock

Front and rear view



Supplied accessory



PSU-12VU Universal DC adaptor (Part No: 1180 0051)

Wall power adaptor with interchangeable plug for international use.

Universal input: 100-240 V AC, 50-60 Hz

Output: 12V DC, 2.5 A

Specifications

Data rate:	2.25 Gbps per color
Resolution:	640 x 480 to 1920 x 1200 or 2048 x 1080 deep color
TP cable equalization:	0-40 dB manual or automatic
EDID memory:	1 factory, 9 user learned presets
EDID support:	256 byte Extended EDID
Front panel control:	Yes; EDID selector; EQ setting
HDCP pass through:	Yes
RS-232 pass through:	Yes
Power:	Universal power adaptor, DC 5V 1 A
Power consumption:	4W (typ) 10 W (max)
Enclosure:	1 mm metal
Dimensions:	100.4 W x 67.6 D x 26 H mm
Net weight:	230 g
Compliance:	CE
Warranty:	3 years

Connectors

Input:	Dual-RJ45
Output:	HDMI
Audio output:	S/PDIF (Digital)
RS-232:	9-pole D-sub
USB:	Mini USB-B female connector
Power:	2.0/5.5 mm locking DC connector

Optional accessories



Under desk mounting kit
(Part No: 5240 0275)

The UD-kit makes it easy to mount a single device on any flat surface (e.g. furniture).

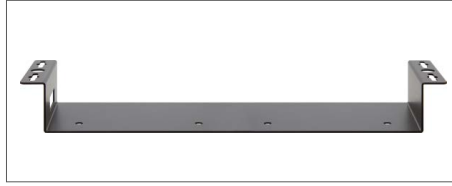

Under desk mounting kit double
(Part No: 5240 0276)

The UD-kit double makes it easy to mount multiple devices on any flat surface (e.g. furniture).

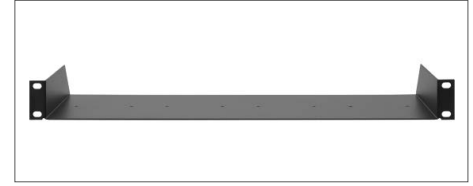

Rack shelf (Part No: 5240 0269)

The 1U high rack shelf provides mounting holes for fastening two half-rack or four quarter-rack sized units.